

# Shadow Auto Sports Meter

## COMMON PARTS

(the following pictures may be different from reality and they are only for reference)

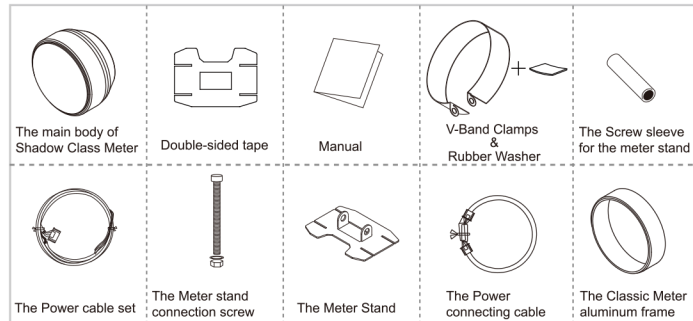

## INDIVIDUAL PARTS

(the following pictures may be different from reality and they are only for reference)

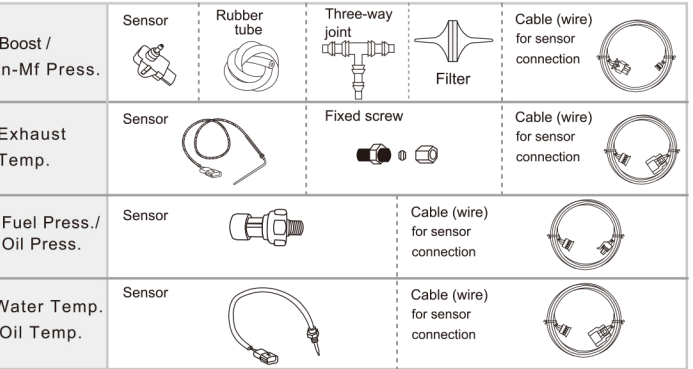

## IMPORTANT

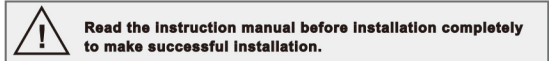

- The damage or unexpected result due to incorrect installation is out of the liability of our warranty, such as reversed connection of the electrode poles or damaged with abnormal usage. Any loss of personal or property due to incorrect usage is out of our liability of responsibility or compensation.

- Never work in a poor air ventilation space. It may cause carbon monoxide poisoning or explosion and injure.

- Please turn off engine at first, then release the negative pole of battery before installation. That can prevent short circuit, catching fire and other parts damaged.

- Don't hurt the outer rubber of the electric cables. The broken cables may cause fire due to short circuit, poor contact etc.
- To pull the harness while driving is very dangerous and might make short circuit.
- To operate this product while driving might cause car accident because of absent-minded.

- Please consult the dealer or professionals before installation if unfamiliar with the cabling method, or you could delegate the installation to the workshop or professionals directly.

- This product is designed for 12V DC vehicles only, it won't work in other vehicle.

- Please connect the harness exactly and firmly. Please seal the soldered joint with insulation tape and make sure no soldered joint exposed without sealing.

- Never rework, disassemble and modify this product.
- Never install at the place with high temperature or humidity. Malfunction could be encountered under these environments.

- Please wait for a few minutes after pasting the double-sided tape on the meter to ensure the adhesion is firmed enough in case of slipping.

## CHARACTERISTICS

- The zero-frictiono super high speed brushless motor makes the incator silently and acutrately run to a ultra high speed of 1200 rad/s.
- The American major manufacturer made chip, precisely collects every information and quickly motivate the indcator to reflect the real-time vehicle status
- Our auto grade turbo pressure sensor has the German standard long life and acurate quilities in oil and temperature resistances.
- The boutique like appearance is built with the innovative hidden gauge holder which is perfectly integrated inside the aluminum frame, and with the precisely diamond cut edge.
- Based on the OE factory made gauge, we add 12LEDs with dual-color LED backlight module to the major scale to make it much clearer and much easier to read.
- There are 12 steps adjustment in brightness. The intensity of lihgt will decrease automatically while the samll lamps are turned on. No glaring for you while driving at night.
- All sensor connectors are equipped with water and weather resistant desgin. No worry for sever weather.
- The gauge runs self diagnostic program function while the system is switched on and off and while the sensor is disconnected. It also contains a warning setup function
- The in-series power connected function is reserved to help save more installation time.

## PRODUCT ASSEMBLY INSTRUCTION

### Product assembling diagram

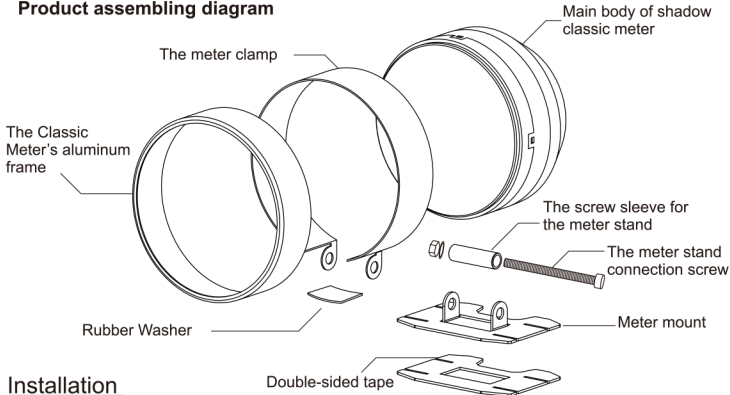

### Installation

Choose the position where you want to install the meter. Please confirm that the driver's sight will not be hindered especially when installing multiple sets of products at the same time. Pull the electric wires along the route of shortest distance to the planned installation position of the meter.

**\*If the aluminum frame is too loose, please equip with the rubber washer on the notch.**

### Clean the area where the meter will be mounted

Keep the installation area dry and clean. Use the proper detergent (for example, alcohol or silicon ester remover) to remove all grease and dirt. Remove all grease and dirt on the meter and the installation area.

### Mounting and fixing the meter

Take down the protective film on the double-sided tape and paste the meter stand carefully to the scheduled installation spot. Please avoid tearing the double-sided tape repeatedly, it will reduce its adhesion.

## CONNECTING

### Wiring method:

- Peel about 10mm from the front wire of the circuit which is about to be connected with.
- Also peel about 10mm on the wire of the circuit which is about to connect with.
- Twine the electric wires.
- Wrap up the electric wires completely with insulation tape and make sure they're wrapped up tightly.

## PRODUCT DESCRIPTION

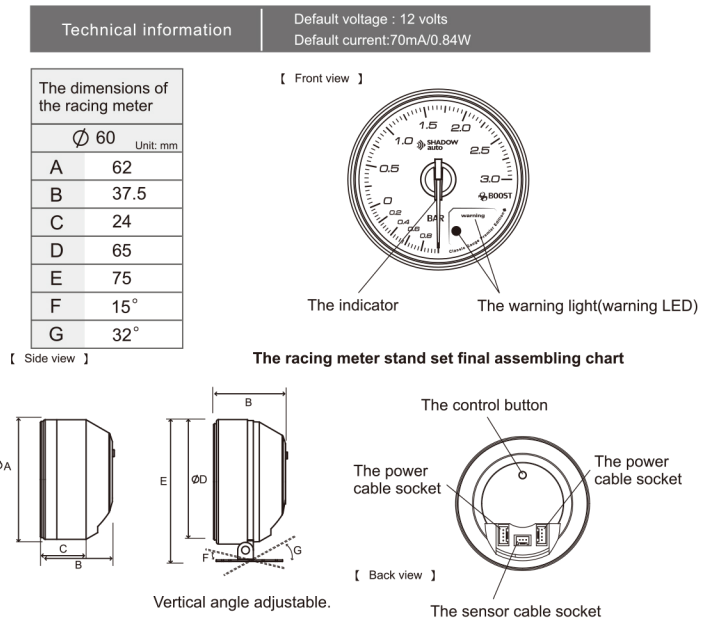

## CABLING METHOD

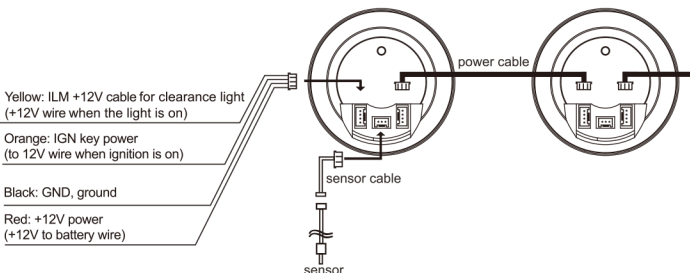

## BACKLIGHT COLOR CHANGING AND THE BRIGHTNESS ADJUSTMENT

The Shadow Classic Meter has two kinds of backlight colors—red and white. After adjusting the brightness from the darkest to the brightest, the backlight color will switch to another one. Afterward, keep pushing the button to find out the most suitable brightness for yourself.

The brightness adjustment consists of day light and night modes. It becomes day light mode right after installation, and automatically goes into night mode when the vehicle's clearance light is on. At the first time entering the night mode, the backlight brightness shall be reset once. After that, the brightness will be dimmed to the setting value while the clearance light is on.

### Setup instruction

Lightly press the button on the back, and will start the light adjustment



## WARNING VALUE SETUP (THE RED LIGHT WILL BE BLINKING WHILE SETTING THE WARNING VALUE)

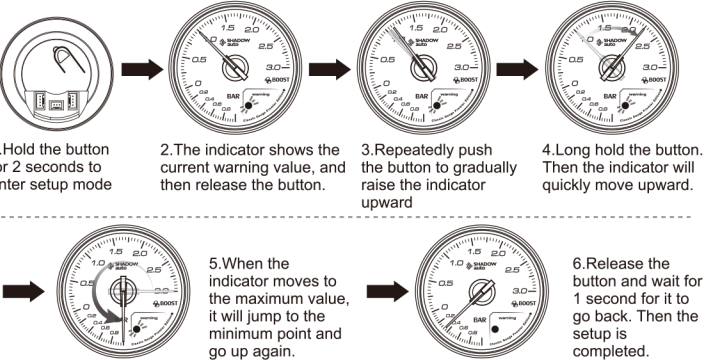

## PEAK VALUE DISPLAY MODE

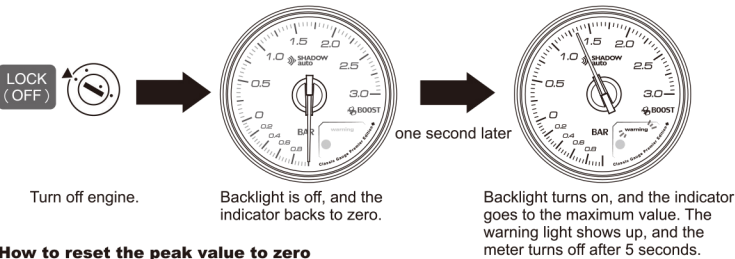

### How to reset the peak value to zero

- After the meter turning off, the peak record will automatically return to zero. When the engine starts, it will generate new peak value.

## SELF-DETECTING MODE

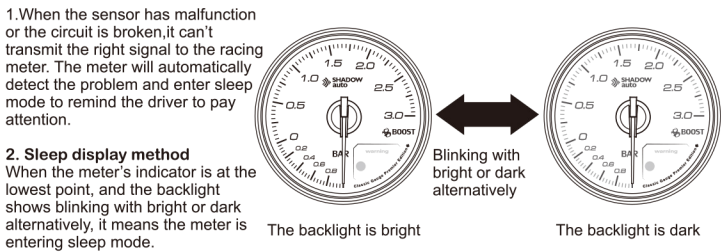

## THE INSTALLATION OF WATER TEMPERATURE METER SENSOR

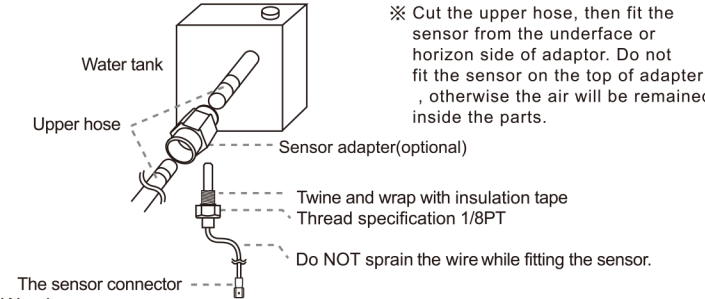

### Warning

Do not twine the wire when locking the screw of sensor with adapter, otherwise the metal inside the wire could be broken and that might make the gauge not working because of bad connection. Must fill up the cooling water pumped during the installation and vacuum the air. The cooling water lacked might cause the engine overheated.

### Confirm

Please lock the sensor with adapter before fitting the sensor wire with sensor in case of sensor wire twined. The thread specification of sensor adapter is 1/8 PT recommended. If the specification is not matched, please consult the dealer or the shop you purchase from for another adapter.

## THE INSTALLATION OF OIL TEMPERATURE / PRESS. METER SENSOR

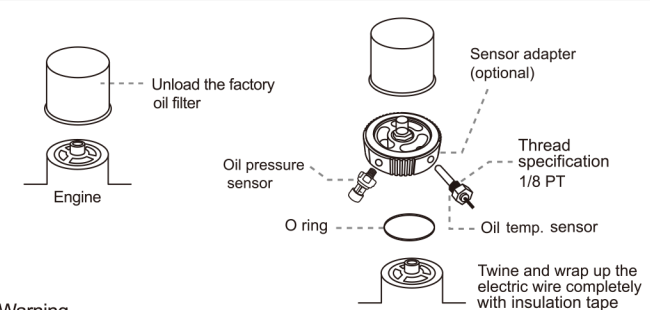

### Warning

- Do not twine the wire when locking the screw of sensor with adapter, otherwise the metal inside the wire could be broken and that might make the gauge not working because of bad connection.
- Must fill up the motor oil leaked during the installation and vacuum the air. Lack of motor oil might damage the engine.

### Confirm

- Please lock the sensor with adapter before fitting the sensor wire with sensor in case of sensor wire twined.
- The thread specification of sensor adapter of 1/8 PT is recommended. If the specification is not matched, please consult the dealer or the shop you purchase from for another adapter.

## THE INSTALLATION OF BOOST METER

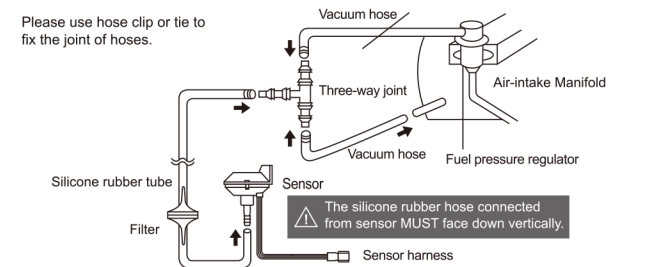

- Please sort the silicone rubber hose connected with boost sensor in the shortest path as possible to ensure the reading is distortionless.
- Please lock the sensor by screws at the place without vibration and high temperature in the engine room.
- Intake pressure is measured from the space among the intake manifold and fuel pressure regulator.
- Cut the vacuum hose extended from the intake manifolds, then connect the vacuum hose to the three-way joint, to connect vacuum hose and the silicone rubber hose if necessary. Use the rest silicone rubber hose to connect the sensor and three-way joint. If the bore of hose is not matched with the intake manifold, use the rest vacuum hose to connect.

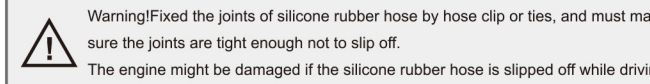

## THE INSTALLATION OF EXHAUST TEMPERATURE METER

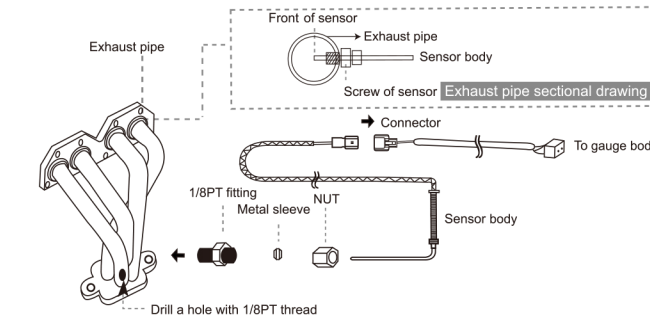

- Loosen the nut from fitting, there is one metal sleeve inside, don't lose the sleeve. Drill one hole on the exhaust pipe by 1/8 pt thread. Then lock the fitting (without sleeve and nut) into the 1/8 pt thread hole.
- Put the front bar of sensor through the nut, then put the sleeve inside the nut through the bar of sensor. Put the sensor through the fitting locked on the pipe, and adjust the position of sensor to make it located in the central hole on pipe; then fasten the nut and fitting.

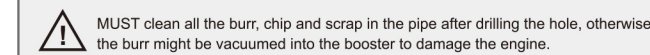

## Shadow Auto CLASSIC Sports Meter Edition Instruction Manual

Publisher : Shadow Auto  
Address : NO.348 Fan-Hwa Road, Chin-Hsin Village, Hsiu-Shui, Chang Hwa, TAIWAN R.O.C  
Website : www.shadowmotor.com.tw  
Tel: 886-4-7681140 Fax: 886-4-7698587 E-mail: autojaw@autojaw.com.tw  
Copyright 2000-2011 AUTO JAW CO., LTD. All Rights Reserved.



Made In Taiwan

ver1.00